

MINI-MARK® Watson Edition Portable Fire Pump



QUICK GUIDE

This Quick Guide shows the basic operation instructions and safety precautions for the WATERAX MINI-MARK Watson Edition portable fire pump.

- The MINI-MARK Watson Edition is a portable single-stage pump-end paired with a Maruyama 50cc 2-cycle engine.
- For full specifications and performance curves, see the *MINI-MARK Data Sheet*.



Warnings and Safety Precautions

This warning label appears on the MINI-MARK Watson Edition pump to identify safety hazards as follows:



Read Your Owner's Manual

The improper use of this pump could result in serious injuries as well as damage to the unit. Read the *Owner's Manual* before using your pump unit and follow the safety instructions in this Quick Guide. It contains very important safety information that **MUST** be read, understood and followed to safeguard you and your equipment from harm and damage. **This pump must only be operated by trained personnel.**



Warnings

- Do not operate if mentally or physically fatigued.
- Always inspect hoses and piping to avoid burst injuries.
- No modification and/or alteration may be made to the pump. Any such modifications void the pump warranty and can endanger pump operators.
- Do not operate the pump above the maximum rated pressure of 120 psi (8.3 bar). Use only pipe, hose, and fittings rated at or above the max. pressure rating of the pump or system design. Ensure special precautions during tandem pumping and progressive hose lays.
- Max. allowable pump intake pressure: 100 psi (6.9 bar).
- Use slow close valves wherever possible to safeguard operators and prevent damage from water hammer.
- Ensure sufficient lighting (5 lx min.) during operation.
- Dry weight of the unit: 18.5 lbs. (8.4 kg).
- Dimensions: L 13-1/8 x W 12 x H 12-3/4 in (L 33.3 x W 30.5 x H 32.4 cm).



Always wear eye and ear protection when operating the pump unit. Sound level of the unit: 105 dB(A).



Never run the engine in a closed or confined area. Exhaust gas contains carbon monoxide which is poisonous. Avoid inhalation of exhaust gas.



Refuel engine with care. Gasoline is extremely flammable, and gasoline vapor can explode. Refuel in a well-ventilated area, with the engine stopped. Use only fuel and oil type as recommended.



Never touch any exhaust system parts while engine is running. Always allow enough time, after stopping the unit, for proper cooling of these parts and surrounding areas. Wear protective gloves.



Careful not to pinch your fingers. Do not place your fingers near the engine output shaft and clutch when the engine is running.

Preventing Damage to Equipment

- Flush the pump with fresh water if the pump has been used to pump salty, brackish, high mineral content water, water containing debris, or foam injected water. Check that debris is cleared before using the pump again.
- Always draft water using a suction strainer.

QUICK GUIDE

Parts Identification

- A. Engine
- B. Pump Intake (suction)
- C. Pump Discharge
- D. Fuel Tank
- E. Air Filter (not shown)
- F. Choke (not shown)
- G. Carburetor Purge Bulb (not shown)
- H. Control Button
- I. Throttle
- J. Rewind Starter (not shown)
- K. Spark Plug
- L. Muffler & Heat Guard
- M. Carry Handle
- N. Frame
- O. Foot Hold

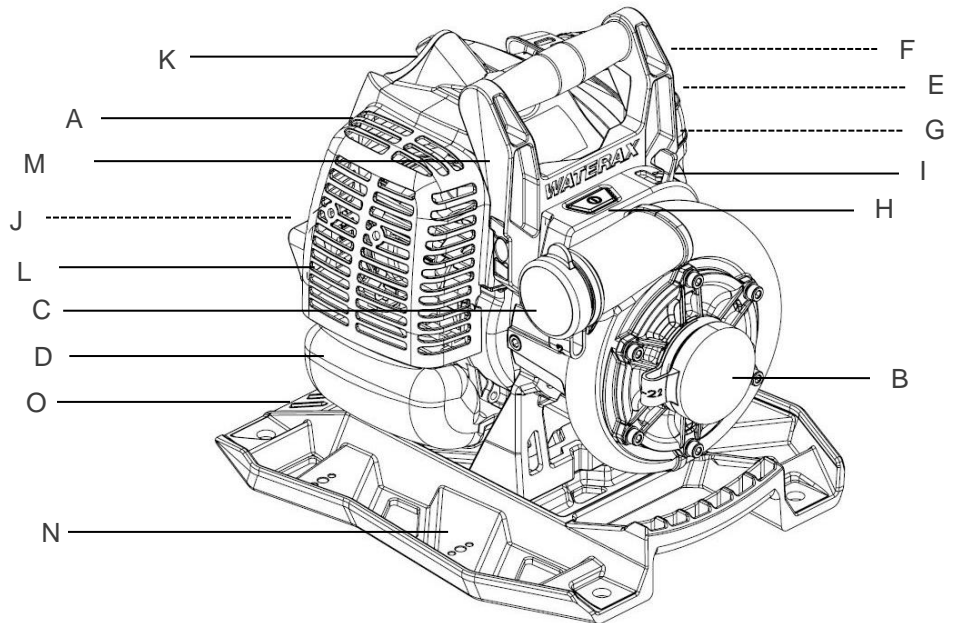

Control Button

The Control Button Assembly continuously monitors the engine speed. In the event of an overspeed condition (e.g., loss of prime), the Control Button will automatically shut down the engine to prevent the risk of damage.



To operate the MINI-MARK® Watson Edition unit:

1. Supply recommended fuel to engine.

- a. Carefully mix the fuel **using fresh 87 octane unleaded automotive gasoline** (max. 10% ethanol) and high quality synthetic two-cycle mixing oil for air cooled engines. Recommended certification: API-TC, JASO-FD and ISO-L-EGD. Recommended oil: Amsoil Saber® Professional Synthetic. Gas/oil ratio: **50:1**. Mix well.

Important: Ensure that the refueling tank is positioned away and at a safe distance from the muffler to avoid any potential accident. Always refuel with care.

- b. Prime carburetor by pressing purge bulb (G) successively until fuel travels up the clear fuel line and appears in the purge bulb.

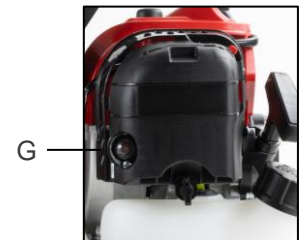

2. Connect foot valve strainer to male end of suction hose, then fill suction hose with water. **Connect suction hose to pump intake.** Use universal hose coupling wrench to tighten coupling firmly.

- ! **DO NOT** run engine with pump disconnected.
- ! **DO NOT** run pump when dry.
- ! **DO NOT** allow foot valve strainer to rest on bottom of lake or riverbed. Check strainer frequently to make sure that it is not clogged with moss, leaves, etc.
- ! **DO NOT** lift strainer from water while the pump is operating. Use a rope or other means to keep strainer at proper height, approximately 1 foot (30 cm) below water surface. If strainer is too close to the water surface, it will draw air and pump may lose prime.

QUICK GUIDE

3. Prime the pump.

Manual priming: Pump can be primed by pouring water into the discharge until full. Pump can also be primed by “jerking” the suction hose until water flows from the pump’s discharge port.

WATERAX hand primer: Connect hand primer to pump discharge. Pump until water is drawn into the pump.

4. Connect the discharge hose, nozzles, etc., to pump, and tighten firmly with coupling wrench.

5. Start the engine.

- Close/engage choke (F), if engine is cold.
 - Move throttle lever to “START/WARM UP” (3 increments from “IDLE”).
 - Slowly crank engine until resistance (past compression).
 - Give starter cord a quick and steady pull.
 - Once engine fires, disengage choke and pull start again if necessary.
 - Allow engine to warm up (approx. 2 min.).
 - Once engine is warm, the unit can be throttled up.
- ! **Important:** failure to allow the engine to warm up may lead to piston scoring and possibly more serious engine damage.

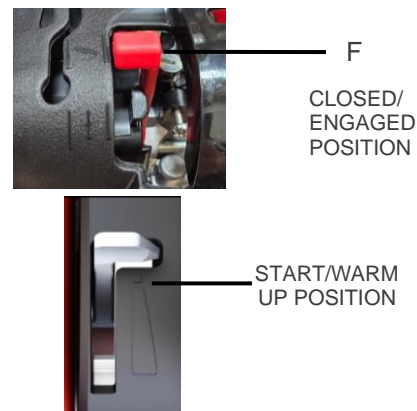

6. Discharge water.

Once the pump is primed, and with the engine running, you can begin to discharge water.

- The pump-end is equipped with a clutch drive system. The clutch will engage at 3900 ± 300 RPM and build pressure.
 - If pressure does not build in the discharge hose at those speeds, the pump has not been fully primed. Prime the pump again.
 - The engine works best at wide open throttle. Vary the discharge nozzle opening to adjust pump performance.
- ! **DO NOT** leave the pump running with all the discharge valves closed for more than one minute, or else the pump may overheat and become damaged. Additionally, the pump end and the water inside it can become extremely hot and cause severe burns. **Careful when opening the discharge valve and avoid touching the pump end.** To avoid this, a re-circulation line (if provided) should be opened or a discharge line left slightly open to allow fresh water to continue to enter the pump.

To shut down and store the MINI-MARK Watson Edition unit:

7. Shut down the pump.

- Gradually reduce the engine speed to idle (lowest speed).
- Allow unit to run for approximately 2 minutes with throttle in this position for proper cool down.
- Press and hold the “OFF” button on the Control Button Assembly until engine shuts down.

8. After final use.

- Carefully empty the fuel tank. Run the engine until it stops to drain the carburetor and fuel system.
- Drain the pump end. If the pump was last run with foam or water that is salty, brackish or high in mineral content, flush the pump with fresh water for a minimum of 2 minutes or until the water is clear.

Warranty, Service and Support

Product and service documentation such as tech notes, data sheets, manuals and information on the limited warranty provided on products manufactured by WATERAX can be found on our Web site at: www.waterax.com



WATERAX

All information contained in this document including drawings is proprietary to *WATERAX* and may not be copied, reproduced or used in whole or in part without our prior written permission. The information in this document is subject to change without notice. Model displayed with multiple options. Weight and dimensions are approximated and may vary depending on options.

WATERAX INC.
6635 Henri-Bourassa W.
Montreal, QC H4R 1E1
T 514 637-1818
F 514 637-3985
TF 1 855 616-1818
info@waterax.com

waterax.com

To help you stay **#ReadyForWildfires**, we've made a few changes, placing 100% of our focus on manufacturing our core products, portable fire pumps.

To do so, we've established a network of trusted supply and distribution partners that can help us provide *WATERAX* pumps quickly in addition to water-handling equipment and accessories.

For immediate assistance when it comes to pumps and water-handling accessories, please [contact your local dealer](#).

For genuine spare parts, visit our [online store](#).

Copyright © 2025 WATERAX Inc.

Publication Number: 702215, Rev.2 All rights reserved. Printed in Canada.

