

BB-4®-18P Portable



DATA SHEET

HIGH PRESSURE 4-STAGE FIRE PUMP

The **WATERAX BB-4 -18** pump pairs a reliable high performance 4-stage pump end with a powerful **Briggs & Stratton 4-stroke 18 HP** engine to achieve pressures of up to **440 PSI (30.3 BAR)** and flow rates reaching **104 GPM (394 L/Min)**. Strong enough to operate as a source pump for tandem and parallel pumping, it is also optimal for direct attack firefighting, remote watering, sprinkler systems, and is a popular choice for slip-on units.

The **WATERAX** quick release clamp provided on the **BB-4®** pump lets you replace a damaged pump end in the field with minimal equipment downtime. The 4-stage pump end on the **BB-4®** is identical to the pump end on the **MARK-3®** unit, which greatly reduces your spare parts inventory and improves your ability to respond to unforeseen equipment damage. You can also quickly install a mid-range **B2X™** pump end as needed for supply or structure firefighting.

Applications

- Slip-on units
- Attack line firefighting
- Long hose lay for remote watering during firefighting operations
- High elevation firefighting in mountainous areas
- Accuracy in flow trajectory when structure firefighting
- Tandem pumping over long distances
- Parallel pumping for higher volumes

Features and Benefits

- Quick release clamp and swappable pump ends for minimal equipment downtime and inventory
- Sealed bearing to eliminate pump end greasing in the field
- Belt drive system for reliable, low maintenance performance
- Aluminium alloy pump components and anodized parts for lighter weight and greater resistance to corrosion
- Comprehensive user and service manuals
- EPA Certified

SPECIFICATIONS

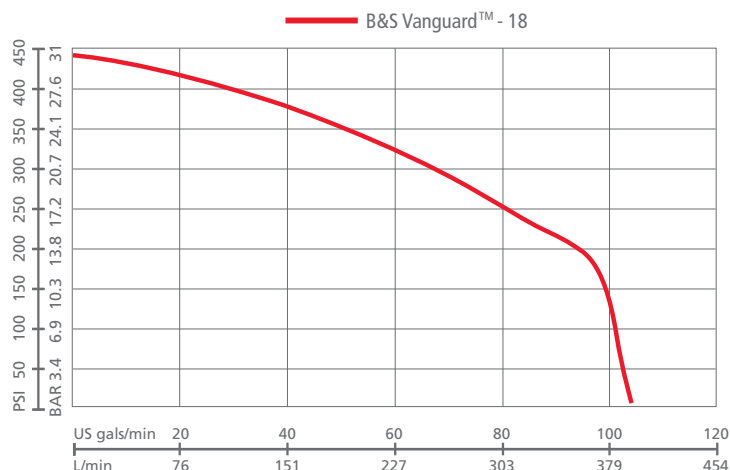

Flow rate at specified pressure

Maximum Pressure: 440 PSI (30.3 bar)
 Free flow: 104 US gals/min (394 L/min)
 Maximum Head: 1016' (310 m)

Flow Rate			Pressure	
US GPM	(LPM)		PSI	(BAR)
100	(379)	@	150	(10.3)
80	(303)	@	250	(17.2)
50	(189)	@	350	(24.1)

Engine: Briggs & Stratton® Vanguard™ - 18 hp



Pump Specifications:

Type:	Detachable 4 stage Centrifugal
Ratings:	ISO 9 and NFPA 1906 Medium Pressure Rating of 50 GPM
Description:	High Pressure, Medium Flow, Foam Compatible
Maximum Allowable Pressure:	600 PSI (41.4 bar)
Intake:	2" Male NPSH Thread
Discharge:	Check Valve: 1-1/2" male NPSH thread (meets US Forest Service Specification 5100-382)
Priming Port:	1-1/2" Male NPSH Thread
Body & Diffusers:	Anodized corrosive resistant aluminum
Impellers:	3.67" Diameter; Anodized corrosive resistant aluminum
Pump Shaft:	Stainless Steel
Bearings:	Maintenance Free; sealed ball bearing
Pump Seal:	Heat resistant, Maintenance Free
Clamp:	Hand tight quick release clamp (no tools needed)
Drive Unit:	Timing Belt and Pulley; Speed Increaser
Speed Increaser Position:	Vertical
Drive Ratio:	1.88: 1
Color:	Red
Special Feature:	The entire pump separates completely from the engine/speed increaser.

Engine Specifications:

Model & Type:	Briggs and Stratton Vanguard 4-cycle, horizontal shaft, twin cylinder, OHV
Maximum Power:	18 HP (13.4 kW) @ 4000 RPM
Maximum Torque:	26.9 lb-ft (36.5 Nm) @ 2800 RPM
Bore & Stroke:	2.83 x 2.76 inches (72 x 70 mm)
Displacement:	34.78 cubic inches (570 cc)
Starting System:	Re-coil start with 12 VDC electric start option
Ignition:	Magnatron
Charging:	16 AMP regulating alternator
Governor:	Mechanical
Cooling:	Air Cooled
Lubrication:	Oil, Full pressure
Oil Capacity:	1.8 quarts (1.7 liters)
Fuel Pump:	18 inch lift.
Emissions:	Meets current CARB, EPA, and CE requirements.
Fuel Type:	Gasoline [unleaded, 86 minimum octane, 10% maximum ethanol]
Fuel Consumption:	1.6 US gals/hr (6.1 liters/hr)
Optional Integrated Fuel Tank Option:	7 US quarts (6.6 liters) with manual shut off valve
Muffler:	Forestry approved spark arrestor



**WE MOVE
WATER**

SPECIFICATIONS

Primer Specifications:

Hand Primer Option:

Inner Option:	Guzzler, Diaphragm Type; Reliable, Lightweight and Rugged
Intake and Discharge Port Size:	½" Female NPT
Construction:	Aluminum Handle, composite body, buna-n reinforced diaphragm and flapper valves
Lift:	12 feet (3.7 m) [up to approximately 16 feet (4.8 m) with suction hose footvalve]
Head Capacity:	30 ft (9.1 m)
Maximum Pressure:	15 PSI (1.03 bar)
Maximum Service Temp:	150° F (66° C)
Volume per Stroke:	0.44 quart (0.42 liter)
Dimensions (L x W x H):	12-3/4" x 4-1/2" x 4-5/16" (324 x 114 x 110 mm)
Weight:	1.70 lbs (0.77 kg)
	Shipped loose with connection hardware and 6 feet of hose

Exhaust Primer Option:

Primer Option:	Venturi Type (when selected mounted to exhaust primer muffler)
Venturi Construction:	Brass
Exhaust Valve Construction:	Aluminum with stainless shaft and disc
Operation:	Remote mount push/pull cable.
Vacuum:	Minimum of 17 in-Hg

Electric Primer Option:

Primer Option:	12 VDC Piston Type Vacuum Pump
Intake and Discharge Port Size:	3/8" Female NPT
Construction:	Corrosion Resistant Aluminum with Bronze Sleeve and Composite Piston
Max. Current Draw:	105 amps
Lift:	25 feet (7.6 m)
Vacuum:	22 in-Hg
Dimensions:	9" x 4-1/8" x 7-1/2" (229 x 105 x 191 mm)
Weight:	8.1 lbs (3.7 kg)
Vehicle Units:	Shipped loose with mounting plate, hardware, and 6 feet of hose

Frame Specifications:

Color:	Black
Finish:	Powder Coat
Handles:	Tubular U-shaped integrated into the base frame

Controls Specifications:

Briggs & Stratton Standard Engine Controls:

Start/Stop:	Turn-key rotary switch
Throttle:	Lever control on left side of blower housing
Choke:	Push/pull ring pin located on starter side of the engine below the air filter housing.

Engine Mount Control Panel:

On/Off Switch:	Weather resistant chrome toggle switch
Start:	Weather resistant push button switch (with battery kit option only)
Throttle:	Vernier with red push button emergency throttle idle
Low Oil Pressure Warning:	Red LED (with battery kit option only)
Choke:	Push/pull ring pin located on starter side of the engine below the air filter housing.

Discharge Gauge Specifications:

0 to 600 PSI Dual unit (PSI/kilopascals) liquid filled; Pump mounted.



PRODUCT SELECTION

PRODUCT SELECTION MATRIX

			BB-4-18P	BB-4-18PTC	BB-4-18PXTC	BB-4-18PETC
STANDARD INCLUSIONS	Primer	Guzzler Hand Primer	S	S	-	-
		Remote Exhaust Primer w/Control Cable PART-763	-	-	-	-
		Exhaust Primer	-	-	-	S
		Electric Package - Electric Primer, LED work light, & Battery	-	-	-	S
	Muffler	B&S horizontal low tone	-	-	-	-
		Dual B&S low tone	S	S	S	-
		Exhaust primer muffler	-	-	-	S
	Fuel Tank	Integral / 7 US qts (6.6 L)	-	S	S	S
		Integral / 4 US qts (3.8 L) w/ 3-way valve	-	-	-	-
	Controls	Engine Mount Control Panel	-	S	S	S
	Discharge Gauge	0-600 psi, 2-1/2" dial	S	S	S	S
	Check Valve Manifold	1-1/2" NPSH	S	S	S	S
	FastWire CTRL Cable	B&S 3' CTRL Cable with 8 pin connector (FWC-B-3)	-	-	-	-
	Weight		167 lbs (76 kg)	172 lbs (78 kg)	176 lbs (80 kg)	194 lbs (88 kg)

OPTIONS & ACCESSORIES

Sold Separately

Electric Kit



BATKIT-20-P
Battery Kit 12V 20ah, Portable



WLIGHTKIT
LED Work Light w/ 5' harness & toggle switch

Fuel Tank & Fuel Line



FA-452
Remote Fuel Tank
6.6 US Gallons w/ quick conn.

12-401B-NS-TRPD
Fuel Line EPA -
quick conn. to hose 1/4"

FA-452-3
Remote Fuel Tank
3.2 US Gallons w/ quick conn.

12-401B-NS-TRPD
Fuel Line -
quick conn. to SAE 45 Flare

Pump Intake & Discharge Adapters



ADP-A-FM20S Adapter 2" NPSH Female to NPSH Male
ADP-A-FM20SP Adapter 2" NPSH Female to NPT Male
ADP-A-FM20SV Adapter 2" NPSH Female to Victaulic
ADP-A-FM15SN Adapter 1-1/2" NPSH Female to NH Male
ADP-A-FM15S Adapter 1-1/2" NPSH Female to NPSH Male
ADP-A-FM15SP Adapter 1-1/2" NPSH Female to NPT Male
ADP-A-FM15SV Adapter 1-1/2" NPSH Female to Victaulic



B-6365
Check valve manifold 1-1/2 NPSH



**WE MOVE
WATER**

TECHNICAL DRAWINGS

BB-4-18P

Length 35" (88.9 cm)

Width 19.75" (50.16 cm)

Height 20.5" (52.07 cm)

Weight 167 lbs (76 kg)

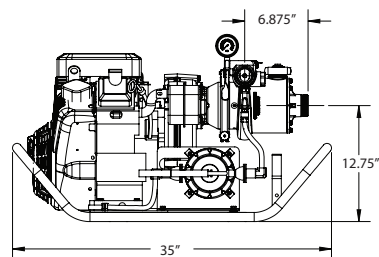
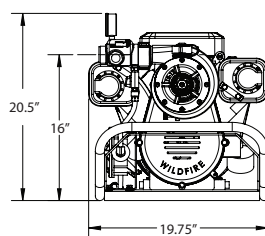
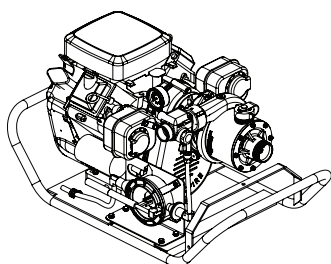

BB-4-18PTC

Length 35" (88.9 cm)

Width 19.75" (50.16 cm)

Height 22.5" (57.15 cm)

Weight 172 lbs (78 kg)

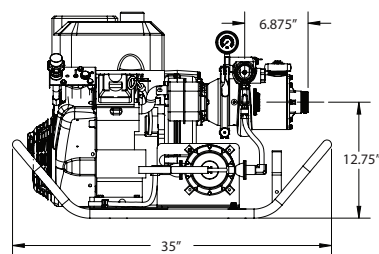
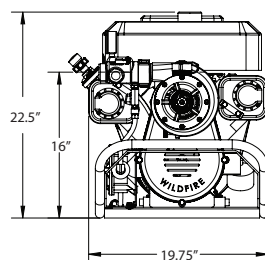
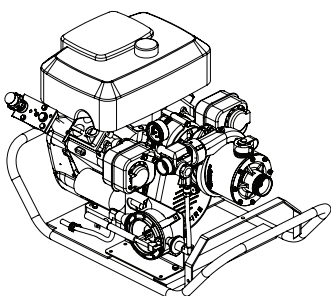

BB-4-18PXTC

Length 35" (88.9 cm)

Width 24" (60.96 cm)

Height 22.5" (57.15 cm)

Weight 176 lbs (80 kg)

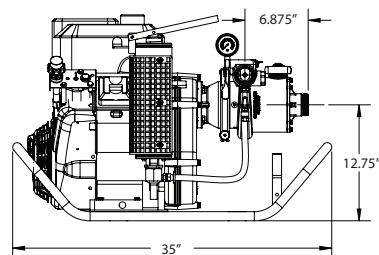
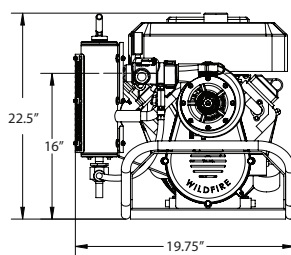
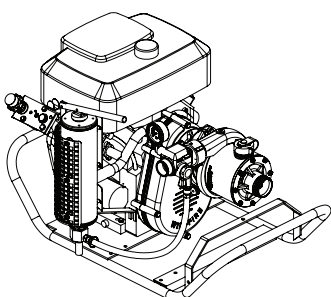

BB-4-18PETC

Length 35" (88.9 cm)

Width 22" (55.88 cm)

Height 23.25" (59.05 cm)

Weight 194 lbs (88 kg)

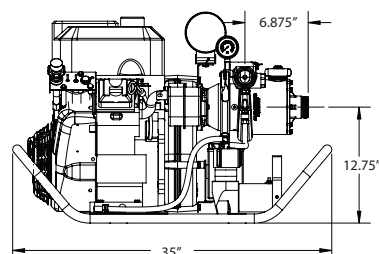
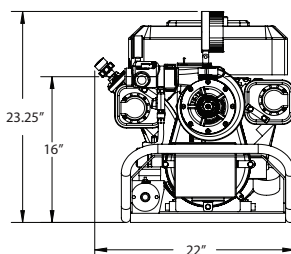
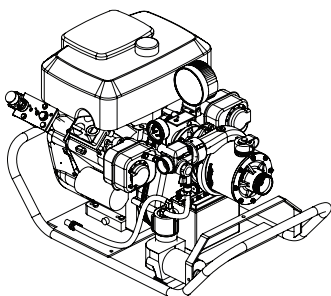

**WE MOVE
WATER**

WATERAX

All information contained in this document including drawings is proprietary to *WATERAX* and may not be copied, reproduced or used in whole or in part without our prior written permission. The information in this document is subject to change without notice. Model displayed with multiple options. Weight and dimensions are approximated and may vary depending on options.

WATERAX INC.

6635 Henri-Bourassa W.
Montreal, QC H4R 1E1

T 514 637-1818

F 514 637-3985

TF 1 855 616 616-1818

info@waterax.com

waterax.com

To help you stay **#ReadyForWildfires**, we've made a few changes, placing 100% of our focus on manufacturing our core products, portable fire pumps.

To do so, we've established a network of trusted supply and distribution partners that can help us provide *WATERAX* pumps quickly in addition to water-handling equipment and accessories.

For immediate assistance when it comes to pumps and water-handling accessories, please contact your local dealer.

For genuine spare parts, visit our online store.

BB-4® is a trademark of Waterax.



**WE MOVE
WATER**